

FORM 163-210 REV. 2.0 07/12/00		INCH (METRIC)	
QUALITY ENG.		MFG. ENG.	
DESIGN BY BJP 10/12/00		CHECKED BY BJP 10/12/00	
DRAWN BY TJZ 10/11/00		MATERIAL	
HEAT TREAT		FINISH	
PROJECT 00076		SURFACE AREA	
PART WT.		PROD CODE	
CUSTOMER		CUSTOMER PART NO.	
PART NAME		SCALE	
030-0900, DR. ENTRANCE		REV. PART NO.	
THIS DRAWING AND THE INFORMATION CONTAINED HEREIN IS THE PROPERTY OF TRI/MARK CORP. AND SHALL NOT BE USED FOR ANY PURPOSE WITHOUT OUR WRITTEN CONSENT.		INDUSTRIAL PUMP 844 Thompson, Iowa 50599 Tel: 641-344-2392 Fax: 641-344-2392	
ATRI/MARK® AN EMPLOYEE-OWNED CORPORATION		DO NOT SCALE DRAWING	
REPORT ERRORS TO ENGINEERING DEPT.		SCALE	
PART NO.		REV.	

ITEM	PART NO.	DESCRIPTION	QTY.
1	17951-01	ASSY, HDL, PLATE, INSIDE	1
2	16004-01	ASSY, HSG/PDL, DBLT	1
3	17999-01	ASSY, 050-0200, RH, 1/4-20, YZC	1
4	15555-01	SCR, MACH, OVH, 8-32X.750	3
5	80844-99	CAP, VINYL	1
6	81480-00	GASKET	1
7	81024-01	SCR, CAP, BTNHD, 1/4-20X1.250	3

PRODUCT SUPPORT DRAWING
Indicate part dimensions on the drawing for
only. Refer to individual part drawings for
complete dimensions and specifications.

SECTION A-A

To Open From
The Inside (Option 2)

Drill hole in location noted in the lower
right hand corner of the inside plate.
Push the release arm to the left to
release the latch assembly.

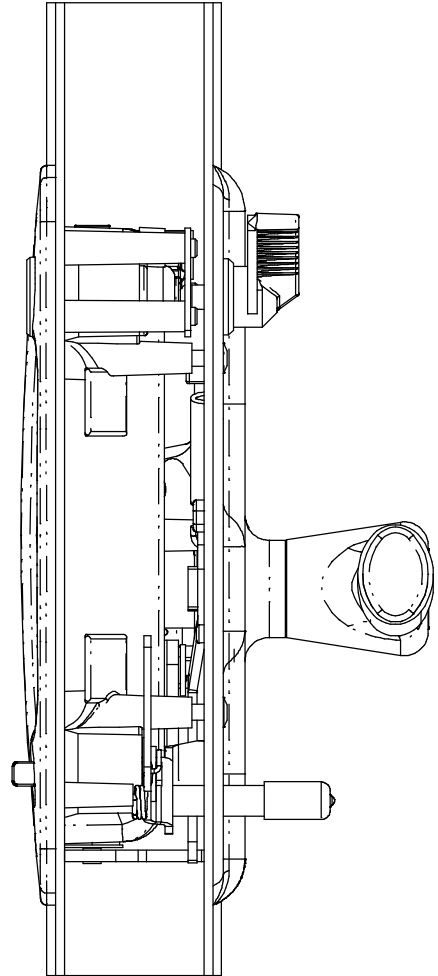
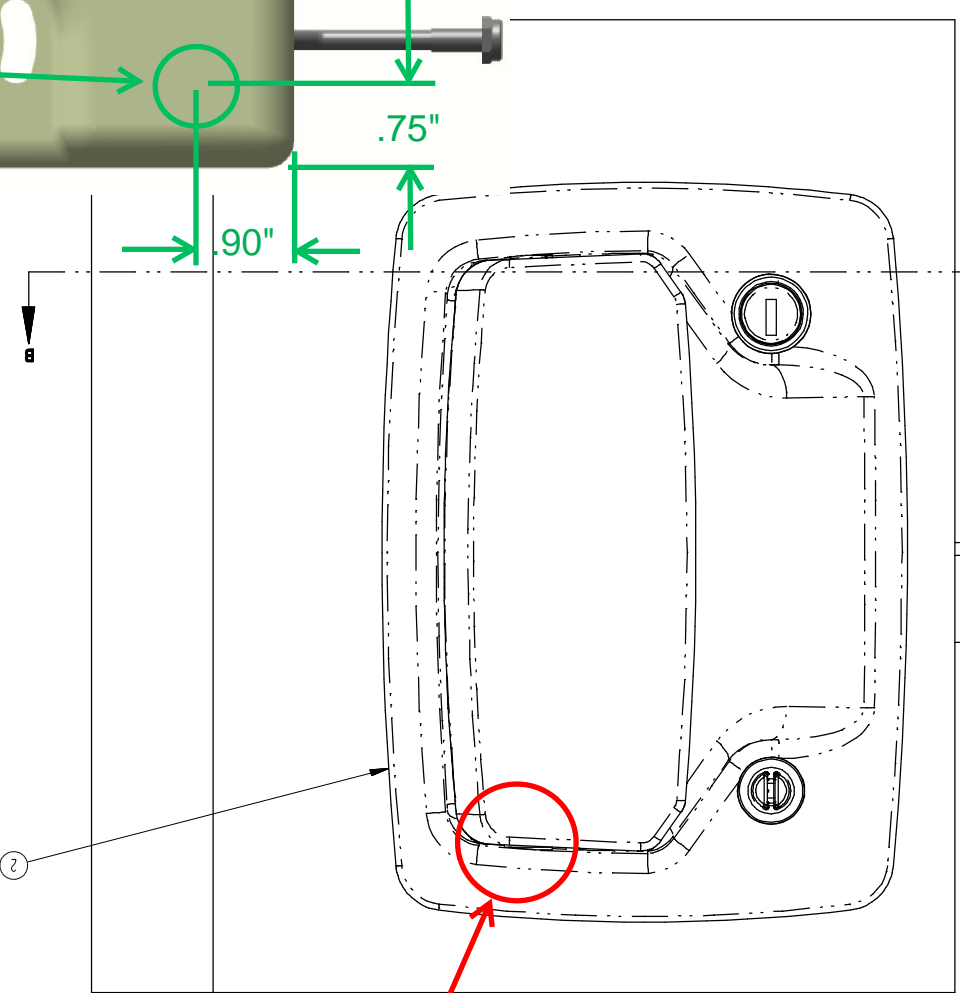
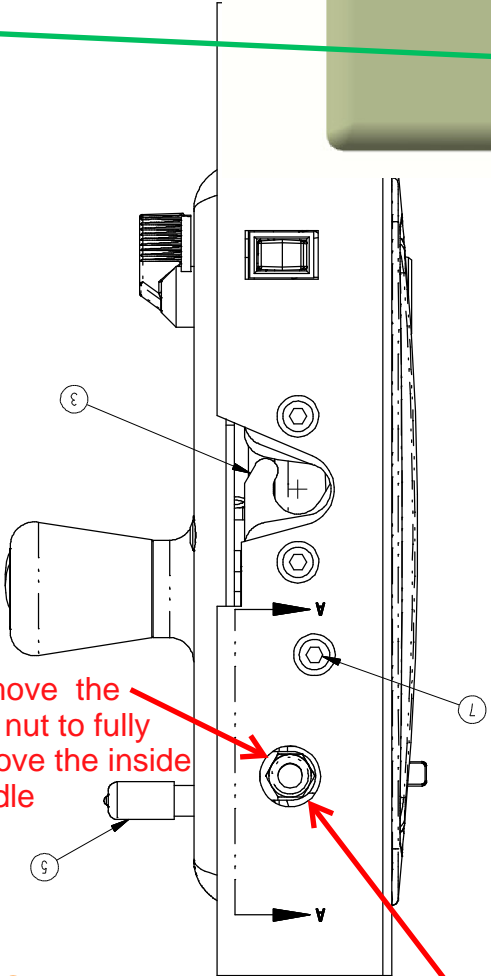
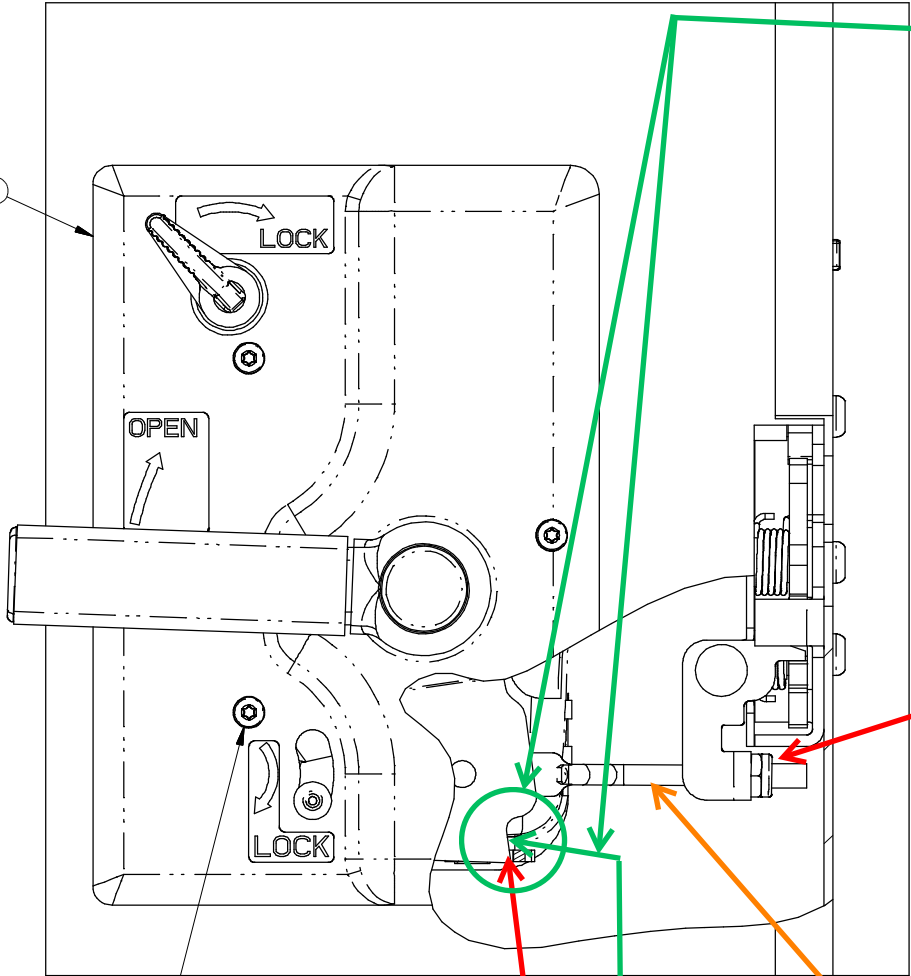
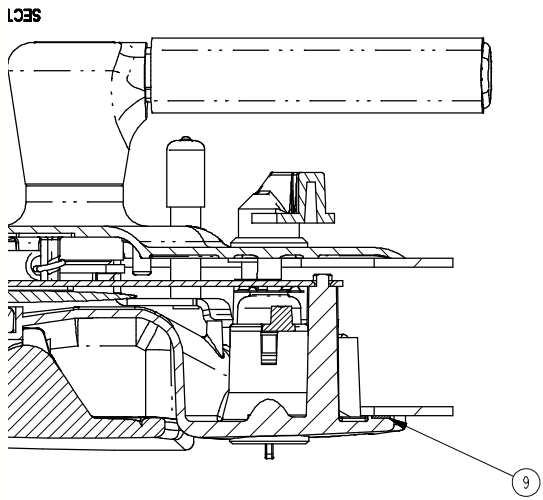
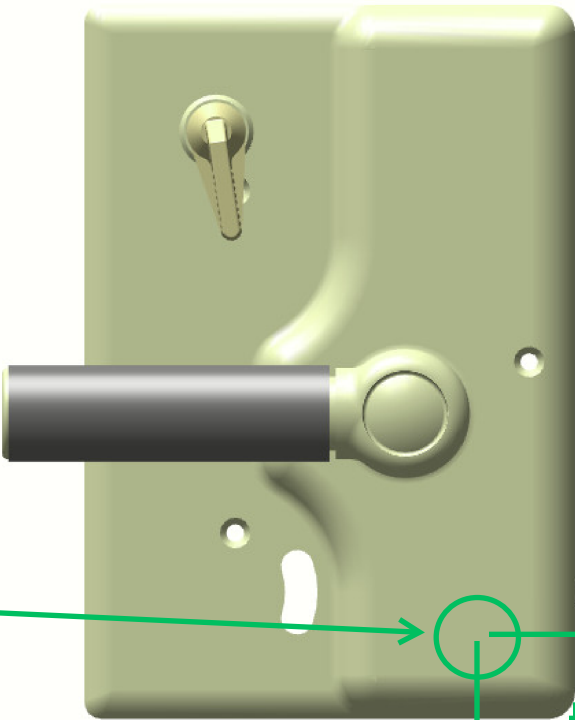

Remove the
lock nut to fully
remove the inside
handle

To Open From
The Inside (Option 1)

If you can gain access to the inside,
you can remove the inside plate assembly
and trip the latch since the release rod is
attached to the inside handle.

The nut is accessed from the
door edge.

Step 2 (Outside)

Once you drill a hole in the outside
handle assembly, you need to rotate
the inside release arm that engages
with the outside handle assembly. Rotate
in a counter-clockwise direction to release
the latch assembly.

To Open From
The Outside

Step 1 (Outside)

Drill hole in this location
from the outside handle assembly

