

CLEANING THE SPARK ARRESTOR

Refer to Table 3 for scheduled cleaning of the spark arrestor muffler (which meets U.S. Forest Service requirements). Cleaning is required for maximum genset performance.

WARNING A hot muffler can cause severe burns. Let the muffler cool down before removing or installing the cleanout plug.

The muffler is mounted inside the genset housing. The cleanout plug is located on the side of the muf-

fler, accessible through the air outlet opening in the bottom of the genset. Clean out the spark arrestor muffler as follows:

1. Remove the cleanout plug from the muffler (Figure 8).
2. Restart the genset and load it nearly to full power. See **LOADING THE GENSET** (Page 9). Let the genset run for about five minutes to expel the soot in the muffler.
3. Stop the genset, allow the muffler to cool down and then reinstall the plug.

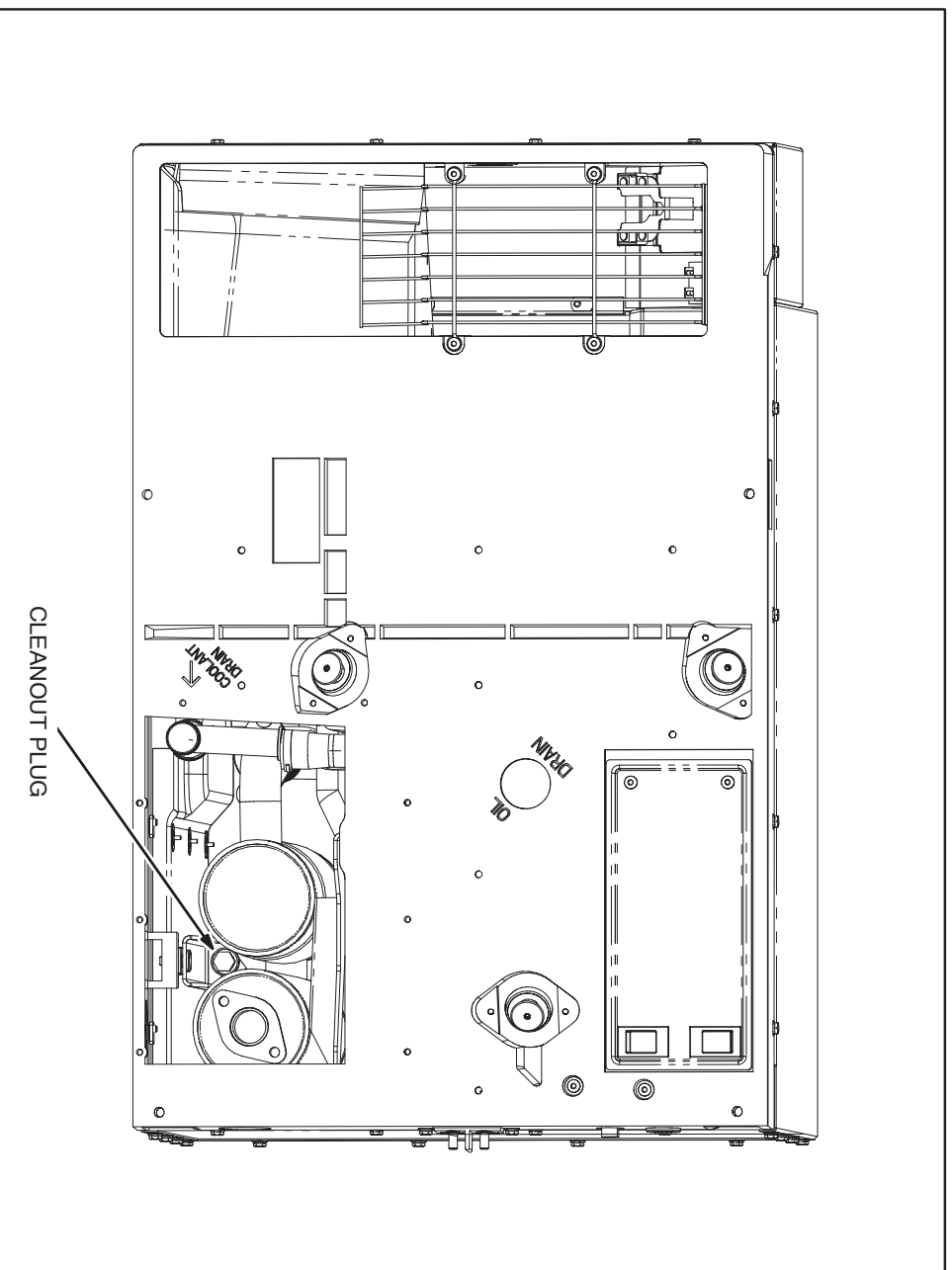

FIGURE 8. SPARK ARRESTOR CLEANOUT PLUG