

DETAIL Z
SCALE 1:4

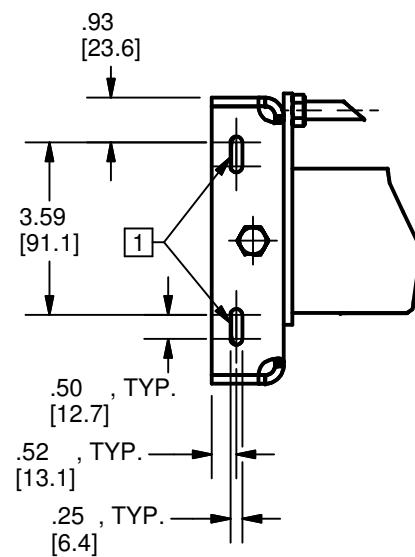

DETAIL Y
SCALE 1:4

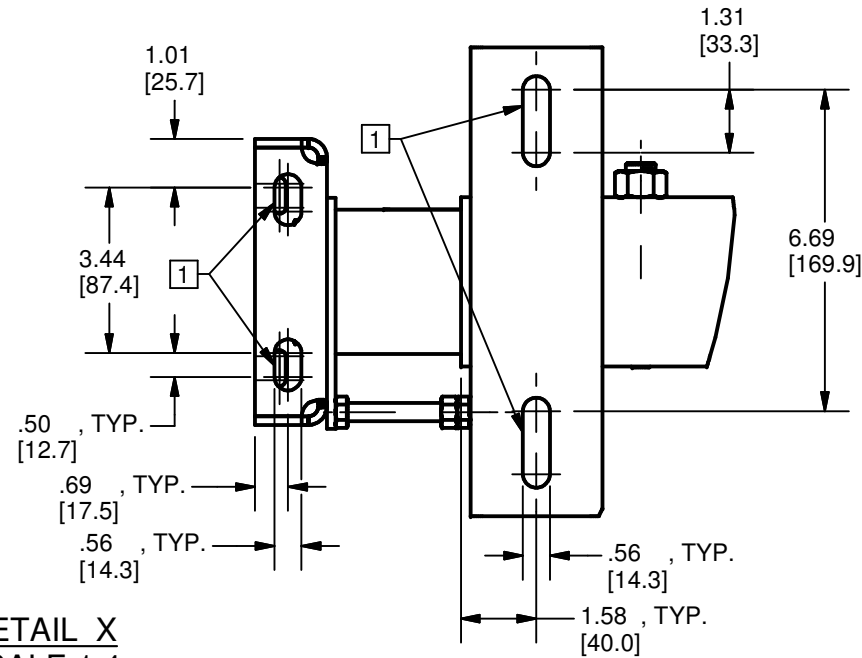

DETAIL X
SCALE 1:4

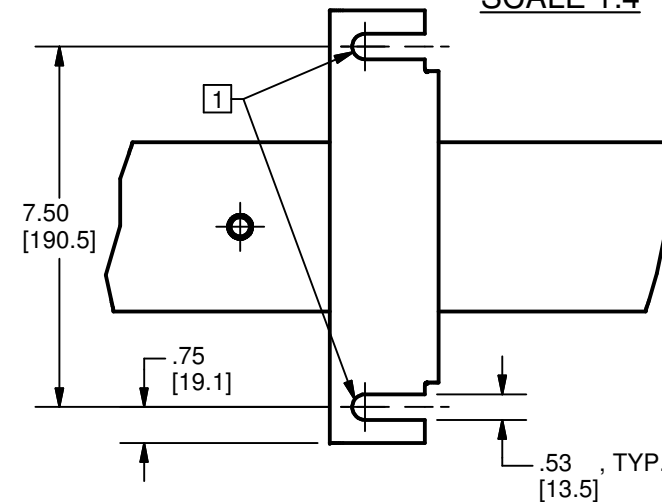

Electrical Characteristics:

- Motor supplied with motor connector comprised of, Packard Female Connector (P/N 12147067), Packard Female Pin (P/N 12147474), Packard Cable Seal (P/N 10738786) and sensor connector comprised of, Packard Female Connector (P/N 12015793), Packard Female Pin (P/N 12089188), Packard Cable Seal (P/N 12015899)
- Slideout rams will extend when (+)12 volts is applied to motor connector Pin A (black wire) & (-) Gnd is applied to Pin B (red wire)
- Sensor wiring; Pin A (white wire) is signal, Pin B (black wire) is (-) Gnd and Pin C (red wire) is (+) power.
- Operating voltage range:
13.3 to 10 VDC, 12VDC nominal
- Nominal Amp draw @ 68°F:
2 A at no load, 15 A at 725 lbs., 40 A at stall (locked rotor)

Mechanical Characteristics (assuming traditional slideout application):

- 20" max. stroke
- 9/32" rail deflection with 450lbs. per rail; Safety factor of 2
- Nominal actuation speed of rails with 12VDC input;
1.5 in/sec. @ no load, 1.0 in/sec. @ 725 in-lbs.
- 1750 lbs. max. rail push/pull force

Environmental requirements:

- External or internal application
- 500 continuous hours of salt spray per ASTM B-117
- Operating temp. range (-40°F to 150°F)

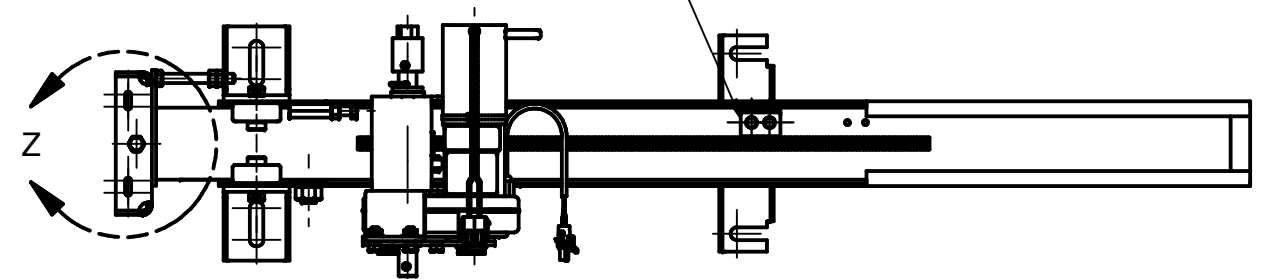
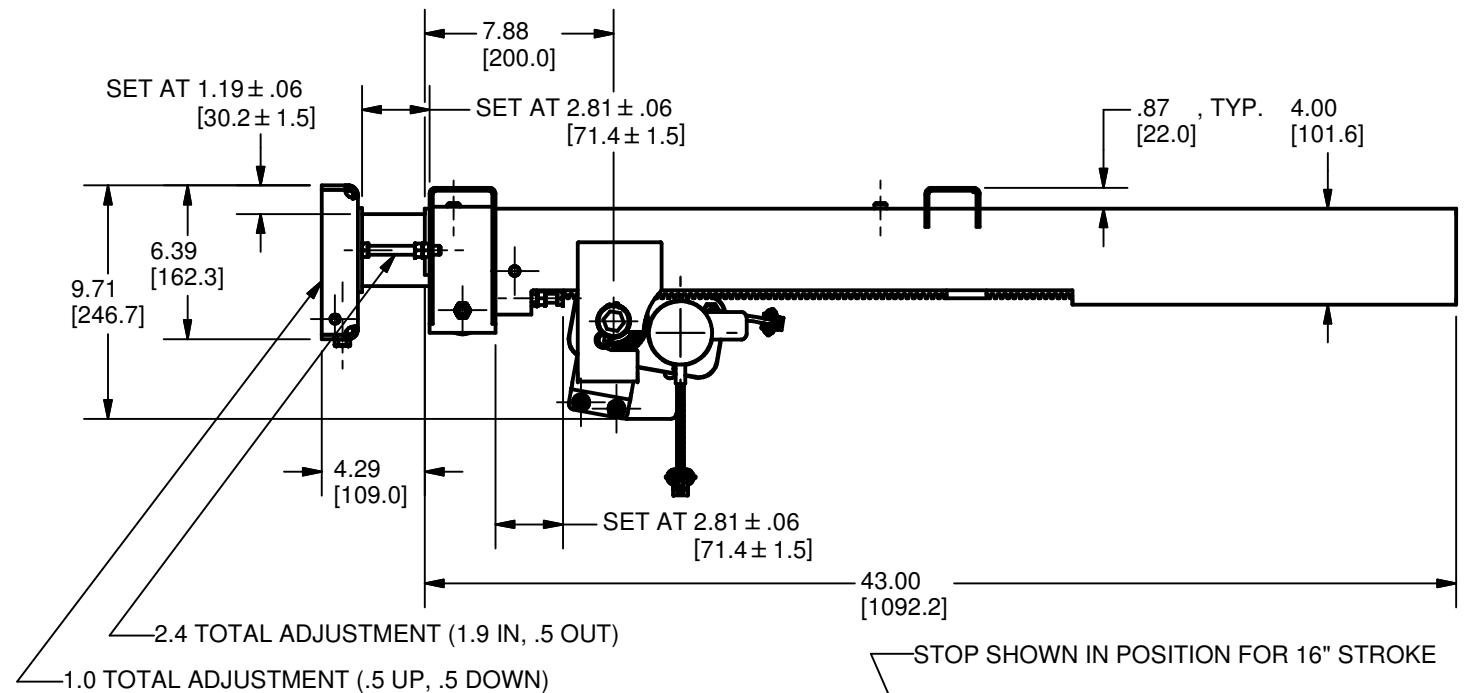
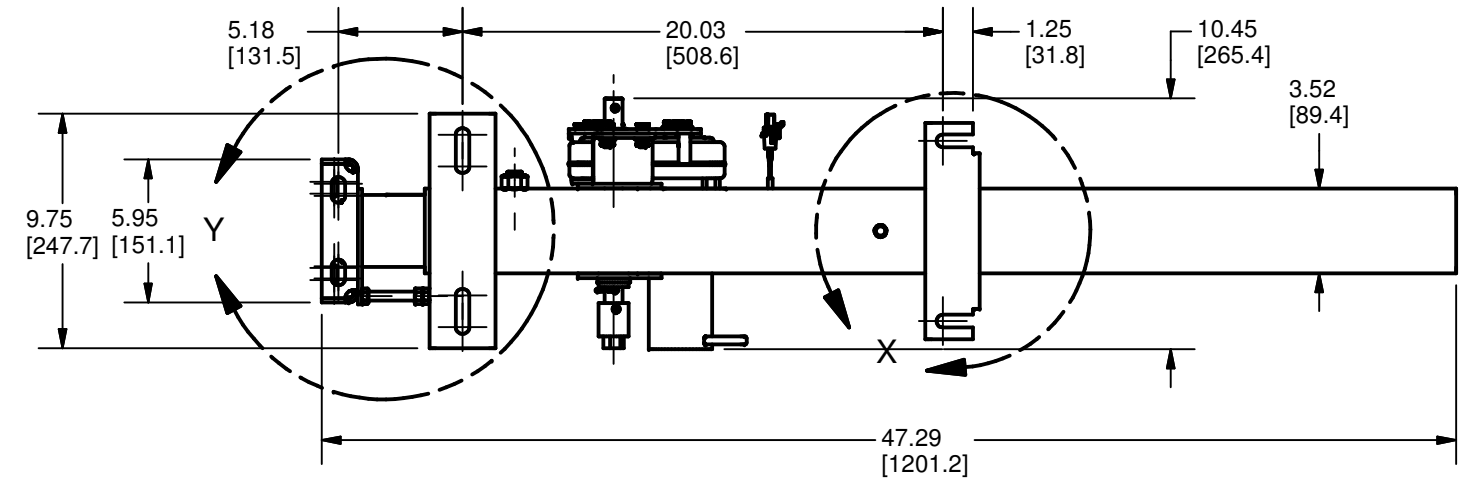

2 - ALL DIMENSIONS WITHOUT TOLERANCES ON THIS SHEET
ARE FOR REFERENCE

[1] - CUSTOMER MOUNTING POINTS

DO NOT SCALE	Power Gear		POWER GEAR JOEY BED KODIAK KWIKEE
	MISHAWAKA, IN USA		REV.
	PART NUMBER 1010001986		0B
	UNITS: INCHES [mm]		SHEET 2 OF 2